

# HEMLOCK RIDGE LOT 1

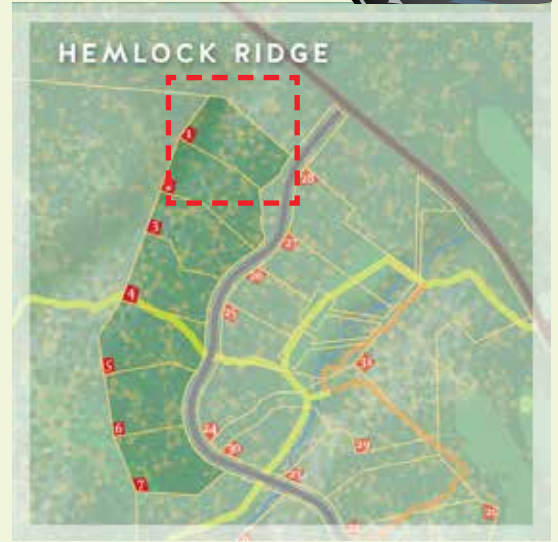

Elegant and majestic, towering hemlocks define the character of these ridge sites. All seven home sites back onto more than 40 acres of unspoiled recreation land replete with trails, craggy cliffs and a critical wildlife corridor connecting the Gatineau Park to the Gatineau River.

Very near the Highlands entry off the 105, Lot #1 is the closest to all local amenities. This property's private home site is located deep in the north end of the property looking out over a wide forest valley of protected recreational wilderness. Mature white pines, hemlock and rock outcroppings feature prominently on this level building site. Beyond the house, the ridge falls away into a deep, untouched valley.

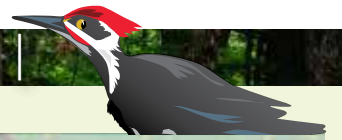

# 1

  
**Highlands**  
À CHELSEA

<b>LOT SIZE</b>	1.17 ACRES / 4754 SQ. M.
<b>FRONTAGE</b>	45.52 M.
<b>DRIVEWAY</b>	SINGLE - 75 M
<b>SERVITUDE</b>	NONE

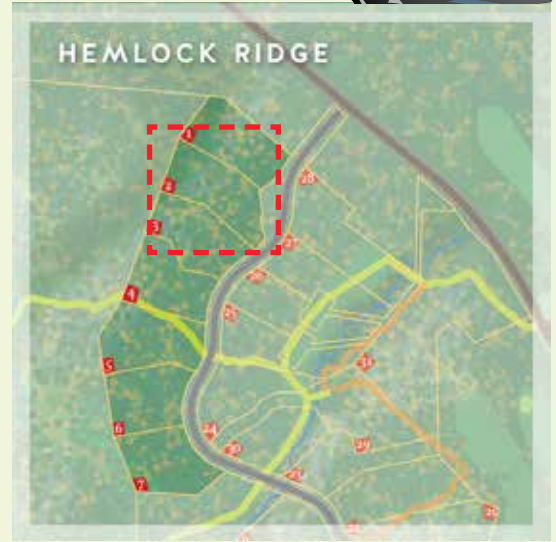

Elegant and majestic, towering hemlocks define the character of these ridge sites. All seven home sites back onto more than 40 acres of unspoiled recreation land replete with trails, craggy cliffs and a critical wildlife corridor connecting the Gatineau Park to the Gatineau River.

**B**ordered by lush ferns, a long stately driveway through a soft and whimsical forest brings you to the north end Lot # 2. Here, the home site has views over a deep wilderness valley to the north-west. Especially private, this easy building site is surrounded by large, mature beech and hemlock trees. This property is perched on a ridge looking over 40 acres of untouched Gatineau highlands.



2

Highlands  
 À CHELSEA

<b>LOT SIZE</b>	1.27 ACRES / 5158 SQ. M.
<b>FRONTAGE</b>	64.23 M.
<b>DRIVEWAY</b>	SINGLE - 94 M
<b>SERVITUDE</b>	NONE



# HEMLOCK RIDGE LOT 3

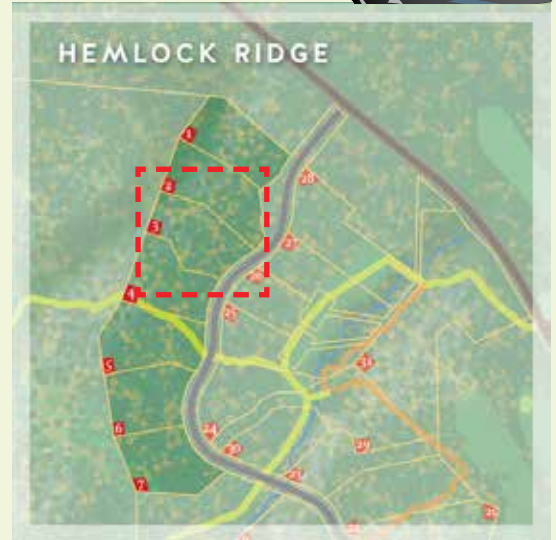

Elegant and majestic, towering hemlocks define the character of these ridge sites. All seven home sites back onto more than 40 acres of unspoiled recreation land replete with trails, craggy cliffs and a critical wildlife corridor connecting the Gatineau Park to the Gatineau River.

A sweeping driveway leads to the heart of Hemlock Ridge and to the Lot # 3 home site. With a deciduous forest to the south and the ridge of towering hemlocks dropping steeply off to the north, this private and serene property feels like the West Coast. There is the possibility of sharing an alternate and more discrete driveway with Lot # 4.



# 3

  
**Highlands**  
À CHELSEA

<b>LOT SIZE</b>	1.25 ACRES / 5039 SQ. M.
<b>FRONTAGE</b>	45.12 M.
<b>DRIVEWAY</b>	SHARED (OPTIONAL) - 52 M
<b>SERVITUDE</b>	NONE

# HEMLOCK RIDGE LOT 4

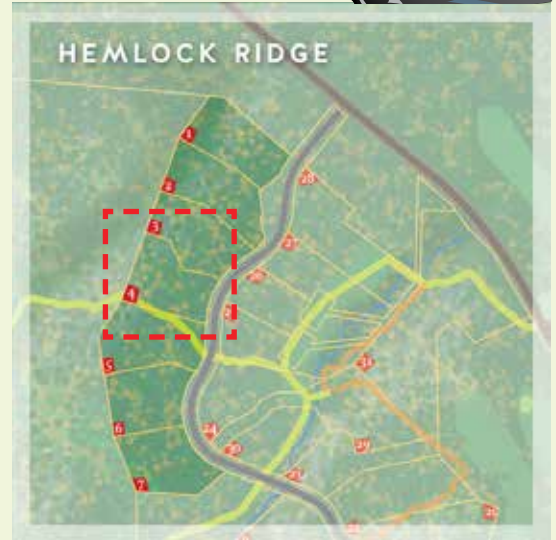
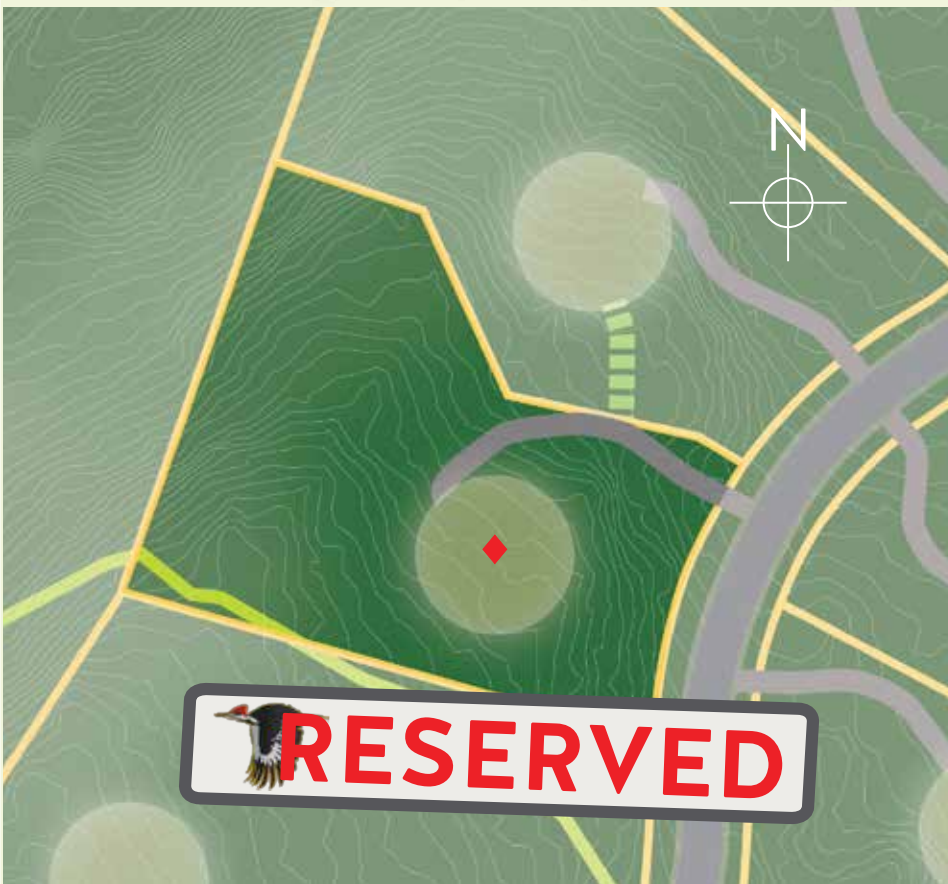
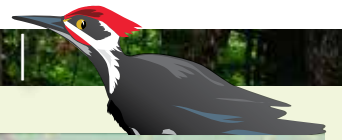

Elegant and majestic, towering hemlocks define the character of these ridge sites. All seven home sites back onto more than 40 acres of unspoiled recreation land replete with trails, craggy cliffs and a critical wildlife corridor connecting the Gatineau Park to the Gatineau River.

Well above the road, high on the Ridge, Lot # 4 has a large flat building site and views out over the recreational lands beyond the ridge. Southern sun makes this a light-filled and inviting property. With the West Trail just 300 m further up the Ridge, this place is ideal for hikers, bikers and nature lovers wanting wilderness at their doorstep. The approach to this home site is one of the most beautiful in Chelsea Highlands. Without compromising any privacy, there is a possibility to share this driveway access with neighboring Lot # 3.



Highlands  
À CHELSEA

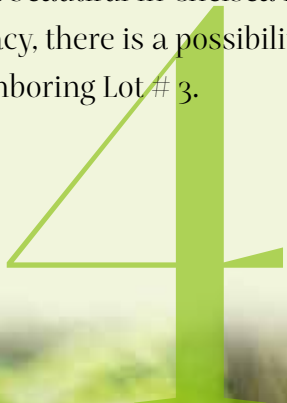

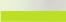
<b>LOT SIZE</b>	1.07 ACRES / 4346 SQ. M.
<b>FRONTAGE</b>	46.11 M.
<b>DRIVEWAY</b>	SHARED (OPTIONAL) - 59 M
<b>SERVITUDE</b>	TRAIL 

# HEMLOCK RIDGE LOT 5

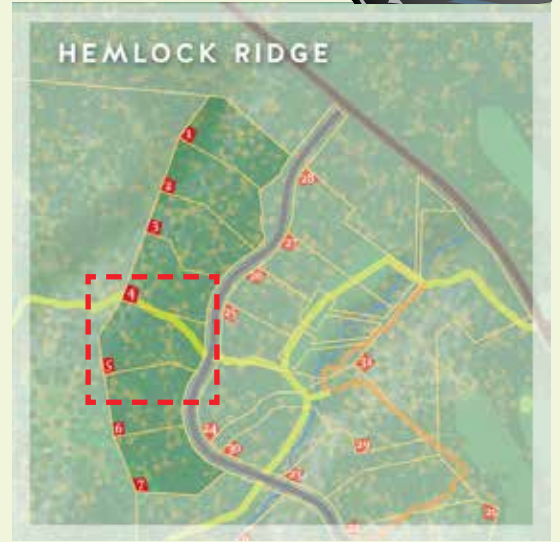
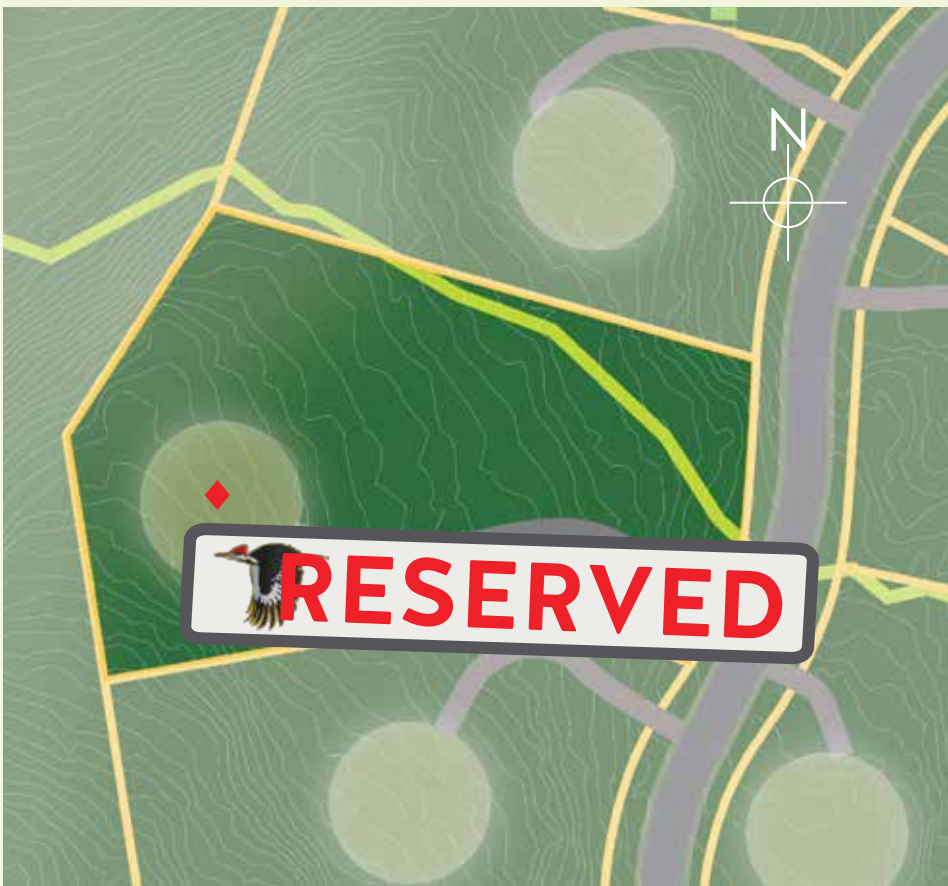
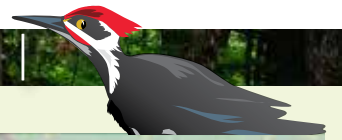

Elegant and majestic, towering hemlocks define the character of these ridge sites. All seven home sites back onto more than 40 acres of unspoiled recreation land replete with trails, craggy cliffs and a critical wildlife corridor connecting the Gatineau Park to the Gatineau River.

The highest of the homes on Hemlock Ridge, lot # 5 has gently sloping topography and easy building possibilities. Tall, majestic hemlocks and an open forest define the property. Early evening light casts a warm glow across the property. A few hundred meters from the home site, the West Trail leads you either down to the community gardens or into the pristine recreational lands to the west.



# 5

  
**Highlands**  
À CHELSEA

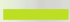
<b>LOT SIZE</b>	1.33 ACRES / 5398 SQ. M.
<b>FRONTAGE</b>	48.59 M.
<b>DRIVEWAY</b>	SHARED (OPTIONAL) - 77 M 
<b>SERVITUDE</b>	TRAIL 

# HEMLOCK RIDGE LOT 6

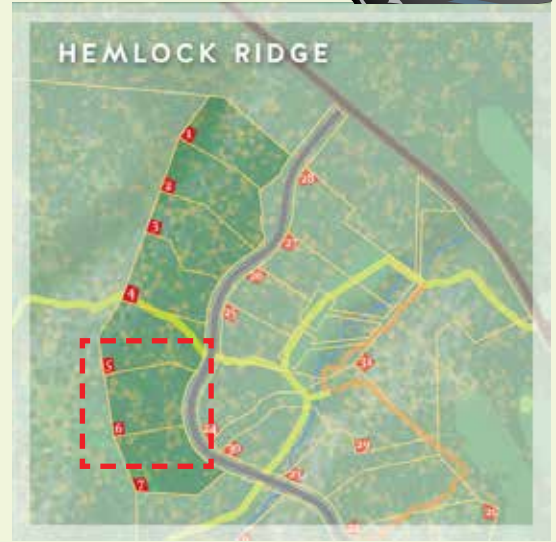
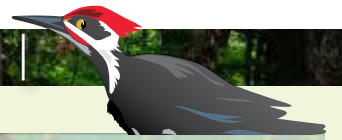

Elegant and majestic, towering hemlocks define the character of these ridge sites. All seven home sites back onto more than 40 acres of unspoiled recreation land replete with trails, craggy cliffs and a critical wildlife corridor connecting the Gatineau Park to the Gatineau River.

Lot # 6 has a discrete and hidden driveway that offers a circling reveal of the home site around a beautiful erratic. This bright and sunny site sits on a natural dividing line between the grand hemlock forest and a softer deciduous forest to the south. With small rocky cliffs to the back of the home site, Lot # 6 is one of the most sought-after properties on Hemlock Ridge.

# 6



  
**Highlands**  
À CHELSEA

<b>LOT SIZE</b>	1.13 ACRES / 4555 SQ. M.
<b>FRONTAGE</b>	54.75 M.
<b>DRIVEWAY</b>	SHARED (OPTIONAL) - 52 M 
<b>SERVITUDE</b>	NONE

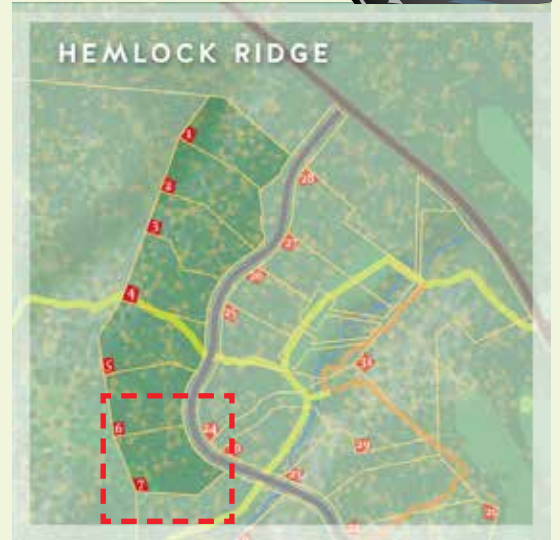

Elegant and majestic, towering hemlocks define the character of these ridge sites. All seven home sites back onto more than 40 acres of unspoiled recreation land replete with trails, craggy cliffs and a critical wildlife corridor connecting the Gatineau Park to the Gatineau River.

With a perfect building site, Lot # 7 is an open, mature forest with several spectacular mature beech trees. The driveway splits away from the main road following the base of a steep wooded hillside. This large property is close to both the West and Woods Trails for a quick access to either the recreational lands to the west or the Community Gardens to the east.



7

Highlands  
À CHELSEA

<b>LOT SIZE</b>	1.12 ACRES / 4536 SQ. M.
<b>FRONTAGE</b>	63.2 M.
<b>DRIVEWAY</b>	SINGLE - 25 M
<b>SERVITUDE</b>	NONE